

# Artex ELT to NAV Interface Kit

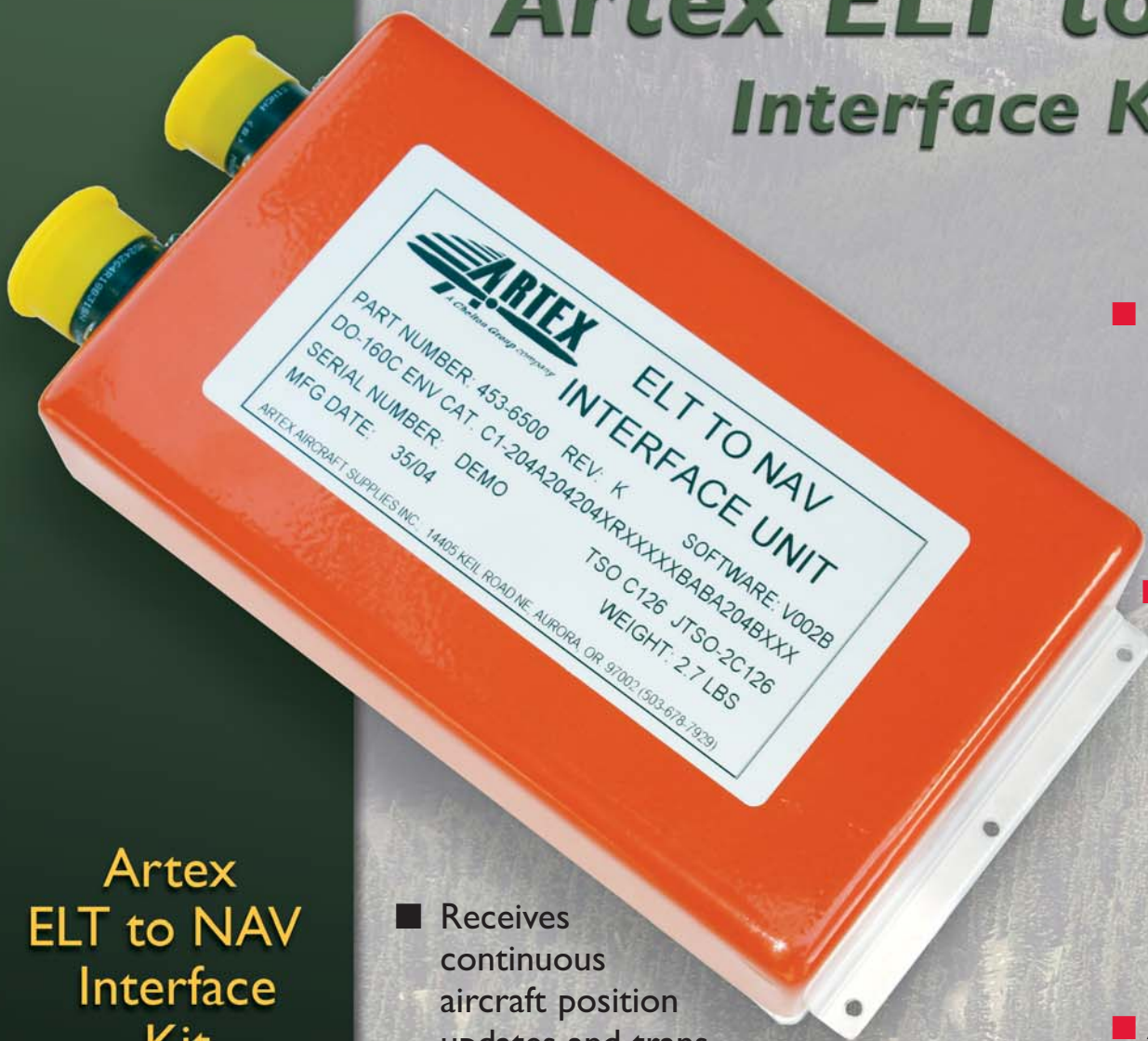

## Artex ELT to NAV Interface Kit

- Receives continuous aircraft position updates and translates to proper format for use by ELT
- Stores Latitude & Longitude of aircraft position with 100 meter accuracy into ELT memory
- For new installations and upgrades of already installed Artex 406 MHz series ELT
- Supports fleet managers with auto re-programming of the aircraft's 24-bit (Standard Message Protocol) address to allow ELT interchangeability within fleets
- TSO C126, ETSO-2C126 approved

- Separate ELT to NAV Interface (to any GPS, FMC or FMS with Arinc 429 or RS-232 databus)
- Designed to connect between the Flight Management Computer (FMC) or GPS receiver and the Artex 406 MHz ELTs (G406-4, C406 series ELT except C406-N).
- Available in Boeing version for B406-4 series ELT



A Cobham Group company

"Saving Lives"

ARTEX AIRCRAFT SUPPLIES  
P.O. Box 1270  
Canby, OR 97013  
email: sales@artex.net  
www.artex.net

Learn more about the ELT to NAV Interface Kit and other Artex products by calling us at 1.800.547.8901 or visiting our web site at [www.artex.net](http://www.artex.net)

560-0082 Rev. C  
DCN 2121 (12-12-02)

## SPECIFICATIONS:

### Unit Weight:

2.7 lbs (1.2 kg)

### Measurements:

9.25"x5"x1.95"

### Vibration:

10 G (5 Hz to 2000 Hz)

### Shock Test:

500 G @ 4 Milliseconds

### Crash Worthiness:

100 G @ 23 Milliseconds

### Altitude:

50,000 feet

### Humidity:

95% for 48 hours

### Impact:

220 PSI (25 kg from 6 inches)

### Crush:

1000 lbs.

### Auto Reprogramming:

24 Bit Aircraft Address (Mode S number)

### ARINC 429 Interface:

ARINC 429 All

### RS-232 Interface:

9600 Baud, Parity: None, Data Bits: 8,  
Stop Bits: 1, STX and ETX required,  
"A" identifier for latitude, "B" identifier for  
longitude

### NAV Systems:

GPS-Loran-Inertial NAV-FMC

### Operating Temperature:

-20°C to +55°C

### Voltage Requirements:

+28VDC ±5VDC

### Current Draw:

300 mA Max.

# Artex ELT to NAV Interface Kit

The Artex "ELT to NAV Interface" is designed to connect between the aircraft's Flight Management Computer (FMC) or GPS receiver and Artex' 406MHz series of ELT's. Its function is to receive continuous position updates from the aircraft's navigation system and translate it to the proper format for use by the ELT. Upon activation, the ELT transmits the Latitude and Longitude of the aircraft to the COSPAS/SARSAT satellite system. Knowledge of the position information allows Search & Rescue forces to launch an immediate mission to the last known position of the aircraft. The ELT/NAV Interface meets the TSO C126 and JTSO-2C126 requirements as a 406 MHz ELT system component. The ELT/NAV Interface is available as a complete kit (P/N 455-6500). The kit includes all required installation hardware (screws, washers, etc.), cable connectors with pins/sockets and a manual.

When properly registered, use of this technology can provide the following information to Search & Rescue teams: 1) Type of aircraft; 2) Owner(s); 3) Emergency Contact(s); 4) Country Code; 5) Aircraft ID or Serial Number of ELT; 6) ELT Manufacturer; 7) Latitude/Longitude Position

An advanced feature of the interface is the ability to custom program the ELT to the "24-bit Address" (Mode S Number) assigned to an aircraft. This is extremely useful for fleet operators who change ELTs in aircraft for maintenance purposes because it eliminates the need to re-program an ELT before it is installed in a different aircraft.

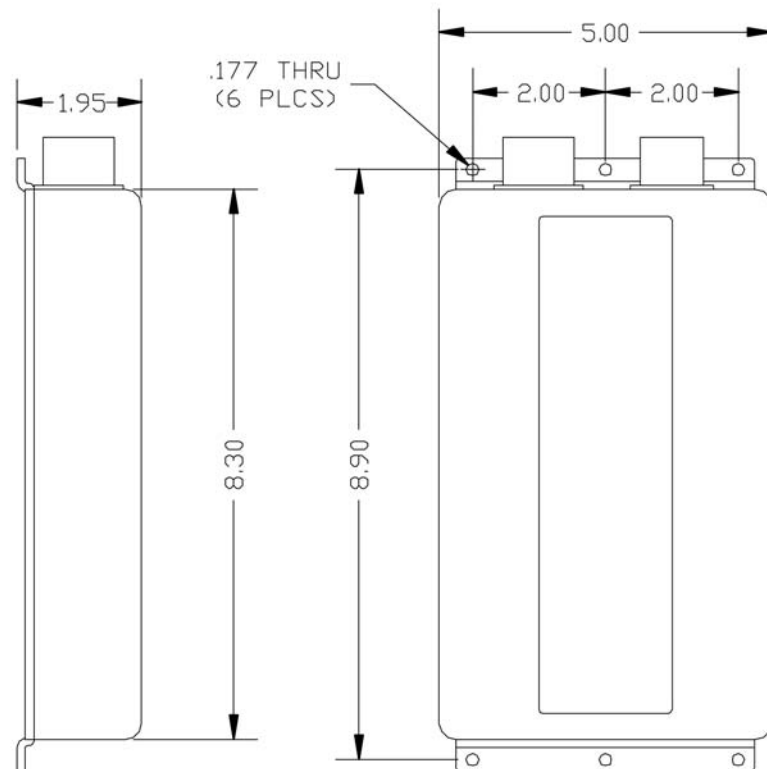

ELT to NAV OUTLINE DRAWING (Dimensions shown in inches)



"Saving Lives"

ARTEX AIRCRAFT SUPPLIES  
P.O. Box 1270  
Canby, OR 97013  
email: [sales@artex.net](mailto:sales@artex.net)  
[www.artex.net](http://www.artex.net)

**Learn more about the ELT to NAV Interface Kit and other Artex products by calling us at 1.800.547.8901 or visiting our web site at [www.artex.net](http://www.artex.net)**

560-0082 Rev. C  
DCN 2121 (12-12-02)